

Blanket Stitch

Use the blanket stitch to finish your edges.
This will prevent your appliqué from fraying.

- 1) Make a knot in the thread and insert the needle from back to front through the background fabric directly against your application (see drawing 1)
- 2) Insert the needle into the fabric 2 to 3 mm from the edge right-angled to the edge and bring it up again with the needle at the starting point (see drawing 2). Pull the needle through the fabric and tighten the thread.
- 3) Insert the needle a few millimeters to the right and again 2 to 3 mm from the edge of the fabric and come up right-angled to the edge (see drawing 3).

Make sure the thread goes under the needle, pull the needle through the fabric and gently tighten the thread.

- 4) Insert the needle a few millimeters to the right into the fabric again, 2 to 3 mm from the edge and come right-angled to the edge with the needle pointing upwards (see drawing 4).

The thread is under the needle again.

Pull the thread to create a decorative edge along your project.

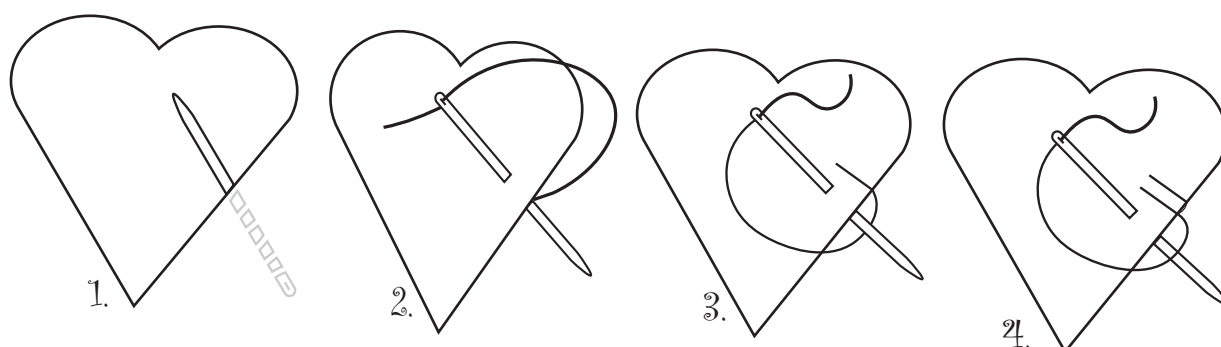

Finish your application in this way. Try to make the stitches equally spaced and the same length.

Make sure the stitches are always right-angled to the edge. Start at a corner or an inlet, this prevents you from having problems with the same distance end from the last stitch.

Below you see the examples of an outer corner (5) of the point of a heart, an inner corner/cove (6) between two arcs of a heart.

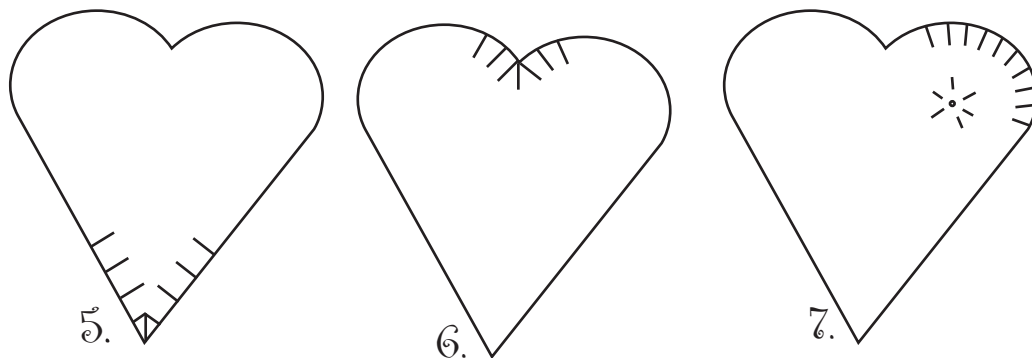

If you need to blanket stitch a curve, take a point in the center of the curve as direction so that the stitches will all point to the center. (you can do this with a water-soluble marker or white pencil) This way the stitches form an even arc.(7)